



PHUKET MARRIOTT RESORT & SPA, MERLIN BEACH

SECLUDED BEACH GETAWAY

Phuket Marriott Resort & Spa, Merlin Beach is a secluded beach getaway close to the enchanting, colorful life of Patong. Ideal for global travelers looking for dynamic culinary delights and cultural experiences, we embrace the essence of Phuket. Through Brilliant Hosting, our associates truly connect with our guests.





DESTINATION

PHUKET, THAILAND

Phuket is more than just an island. It is a hub of once-in-a-life-time experiences featuring island discoveries, culture, history, entertainment, adventure, golfing, snorkeling, diving and beach escapes.

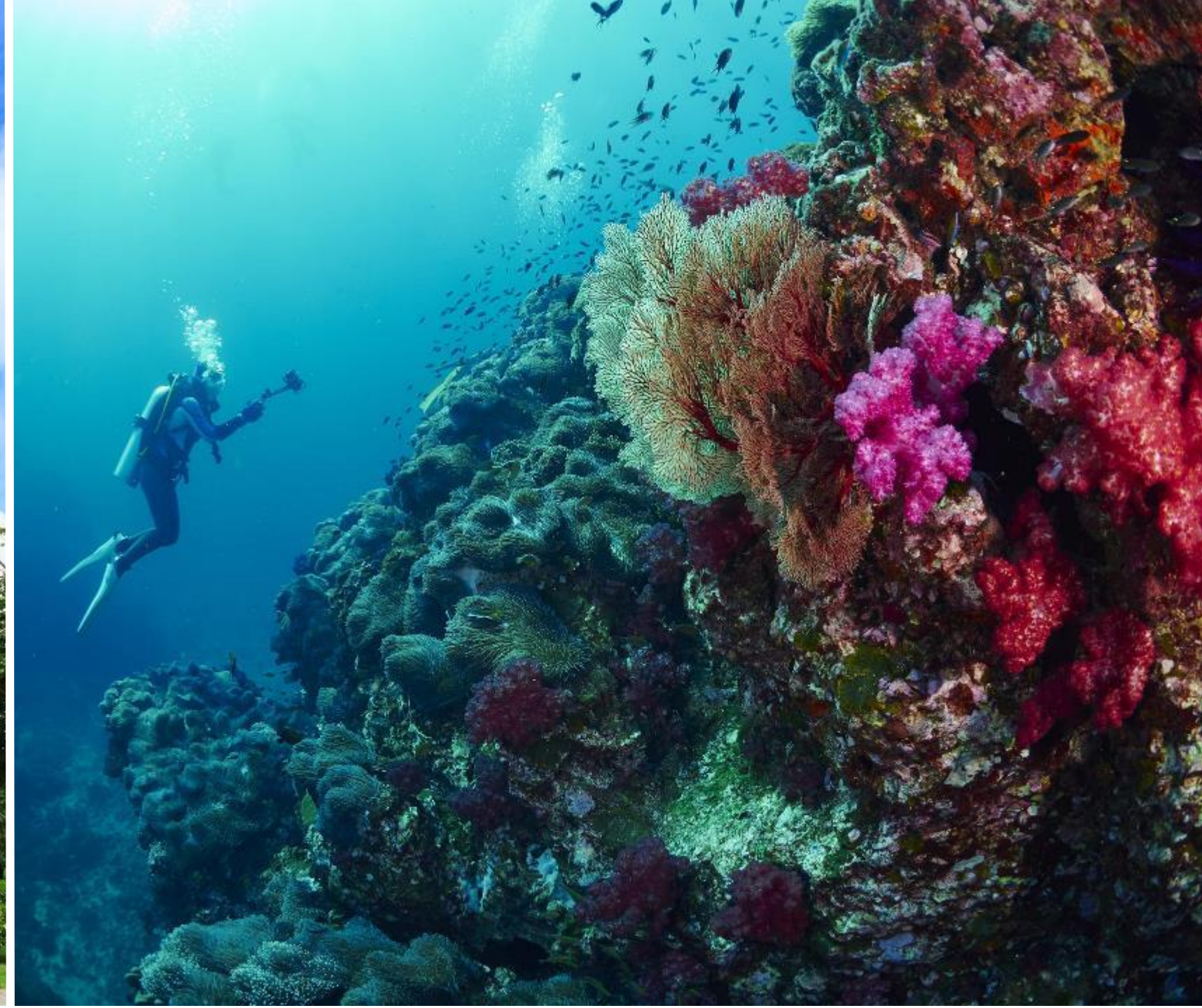



WHERE WE ARE

Phuket International Airport – 50 minutes

Phuket Town – 40 minutes

Patong Beach – 10 minutes

HIGHLIGHTS

- 1 Phuket Marriott Resort & Spa, Merlin Beach
- 2 Tri-Trang Beach
- 3 Patong Beach
- 4 Karon Beach
- 5 Karon View Point
- 6 Big Buddha
- 7 Chalong Temple
- 8 Promthep Cape View Point
- 9 Old Phuket Town
- 10 Phang Nga Bay (James Bond Island)





HOTEL OVERVIEW



414 ROOMS AND SUITES

- 46 Superior Pool View
- 73 Deluxe Lagoon Pool View
- 123 Premier Lagoon Pool View
- 37 Premier Pool Terrace
- 46 Family Premier Room
- 37 Premier Pool Access
- 33 Premier Ocean View
- 12 Premier Beach Access
- 6 Ocean Suite
- 1 Royal Suite



FACILITIES

- 3 Outdoor Swimming Pools including Swim-up Bar, Kids Pool and Splash Pad
- Spa and Fitness Center
- Kids Club and Free Resort Activities
- Merlin Grand Ballroom, 7 Meeting Rooms, Beach Lawn
- Merlin Butterfly Sanctuary
- Merlin House Reef



5 BARS & LOUNGES

- The Lounge
- Pool Bar
- Wellness
- Balls and Burgers
- The Rum Shack



5 RESTAURANTS

- D.O.C.G.
- Merchant Kitchen
- Beach Grill
- Thai Pantry
- Phuket Coffee Co.

WHAT MAKES US UNIQUE



HOUSE REEF

ONE OF THE HEALTHIEST REEFS

The nearshore coral reef is home to diverse species of marine life



BUTTERFLY SANCTUARY

CONSERVATION PROJECT

The first resort in Phuket to bring back the native butterfly population



TRI-TRANG BEACH

SECLUDED BEACH

Located on an isolated stretch of Tri-Trang Beach

ACCOMMODATION

With 10 room types to choose from, guests can get some much-needed rest and enjoy Marriott's signature amenities.



GUEST ROOMS

SUPERIOR POOL VIEW | DELUXE POOL VIEW | POOL ACCESS

46 Superior Pool View Rooms • 41 sqm • 2 twin beds • separate bath tub & shower • upper floor • balcony with pool view

73 Deluxe Pool View Rooms • 41 sqm • 1 king bed • separate bath tub & shower • upper floor • balcony with pool view

37 Premier Pool Access Rooms • 41 sqm • 1 king bed • separate bath tub & shower • ground floor • terrace with direct pool access



Superior Pool View



Deluxe Pool View

GUEST ROOMS

PREMIER POOL VIEW | PREMIER POOL TERRACE | FAMILY PREMIER

123 Premier Pool View Rooms • 43 sqm • 1 king/2 double beds • separate bath tub & shower • upper floor • balcony with pool view

37 Premier Pool Terrace Rooms • 43 sqm • 1 king/2 double beds • separate bath tub & shower • ground floor • private terrace

46 Family Premier Rooms • 86 sqm • 1 king & 2 double beds • interconnecting rooms • upper floor • balcony with pool view



Premier Pool View



Premier Pool Terrace

GUEST ROOMS

PREMIER OCEAN VIEW | PREMIER BEACH ACCESS

43 Premier Ocean View Rooms • 43 sqm • 1 king/2 double beds • separate bath tub & shower • upper floor • balcony with sea view
12 Premier Beach Access Rooms • 43 sqm • 1 king/2 double beds • separate bath tub & shower • ground floor • terrace with beach access



Premier Ocean View



Premier Beach Access

GUEST ROOMS

OCEAN SUITE | ROYAL SUITE

6 Ocean Suites (One Bedroom) • 83 sqm • 1 king • separate bath tub and shower • separate living area • upper floor • private balcony
1 Royal Suite (Two Bedroom) • 100 sqm • 2 bedrooms & 2 bathrooms • 1 king & 2 double beds • spacious living area • private balcony



Ocean Suite

POOLS

There's a pool for everyone. The Family Pool features a kids' pool and water slide. The main pool is a lagoon pool with a swim-up bar. Nahm-Tok pool is a secluded pool surrounded by lush, tropical foliage and mature, tall trees.



THREE OUTDOOR POOLS



NAHM TOK

Depth: 0.50 – 1.40 meters
Opening Hours: 7 am – 9 pm



SWIM UP

Depth: 0.50 – 1.40 meters
Opening Hours: 7 am – 9 pm



FAMILY POOL

Depth: 0.50 – 1.40 meters
Opening Hours: 7 am – 9 pm

SPA AND RECREATION



THE SPA

Located in front of the family pool area with signature treatments including Thai massage, scrubs and wraps.



FITNESS CENTER

Don't miss a workout and shed off those extra pounds at the fitness center complete with state-of-the-art equipment.



KIDS CLUB

Keep the little ones entertained with activities around the clock.

FOOD & BEVERAGE

This Phuket resort offers unique dining experiences that will set a new trend in Phuket. With five restaurants and five bars, you will be spoilt for choice during your stay.



Italian - Dinner

D.O.C.G.

D.O.C.G., signature Italian restaurant, purposefully conveys the Dolce Vita lifestyle in all its senses. Products are imported directly from Italy. The restaurant serves a unique selection of enticing Italian wines and fine cured meats from reputable Salumeria.



International – Breakfast, Lunch, Dinner

Merchant Kitchen

Merchant Kitchen features an open-kitchen concept and made-to-order cooking. Indoor or outdoor seating at the lagoon pool is available.



Casual Grill – Breakfast, Lunch, Dinner

Beach Grill

Beach Grill, a casual grill restaurant, is located next to the family poolside and beachside seats. The restaurant offers pizzas, sandwiches, world-class burgers and catch of the day.



Thai - Dinner

Thai Pantry

Thai Pantry creates an authentic Thai experience with national favorites from all corners of the kingdom. Tantalize your senses with an exquisite balance of local flavors and culinary craftsmanship.



Café

Phuket Coffee Co.

Phuket Coffee Co. is a beachside coffee house, vibrant, modern and chic. Freshly baked artisanal breads and pastries, freshly roasted coffee and other delectable deli items are available.



Lobby Bar

The Lounge

The Lounge captures the guests' imagination as they arrive at the hotel, offering handcrafted food & beverage options throughout the day and into the early hours.



Pool Bar

Pool Bar

Pool Bar is the best spot in the resort to enjoy refreshing drinks and the lagoon pool at the same time. Our team of bartenders will ensure to create a delightful experience.



Beachfront Bar

The Rum Shack

The Rum Shack is a beachfront bar where guests sip cocktails and listen to reggae music amid beautiful sunsets.



Healthy Juice Bar

Wellness

Wellness is a poolside wellness retreat in a rustic, peaceful environment surrounded by lush tropical foliage and a very mature "Pong Pong" tree.



ACTIVITIES

Guests can choose from a variety of recreational and leisure activities such as relaxing spa treatments, water sports or daily classes featuring Muay Thai, yoga and more.



FEATURED ACTIVITIES



FIRE SHOW

Watch dazzling traditional and authentic fire shows every Monday and Friday.



BUTTERFLY SANCTUARY TOUR

Find out how these charismatic insects impact the environment every Monday, Wednesday and Friday.



HOUSE REEF TOUR

Explore marine life in the vicinity and learn the story of the Merlin House Reef.



FOOTBALL MATCH

Friendly matches at the Beach
Lawn.



ZUMBA

Fun and trendy workout.



BILLIARDS

Meet new friends and handle
cues like a pro.



MUAY THAI

Burn calories and learn the
basics of Thailand's national
sport.

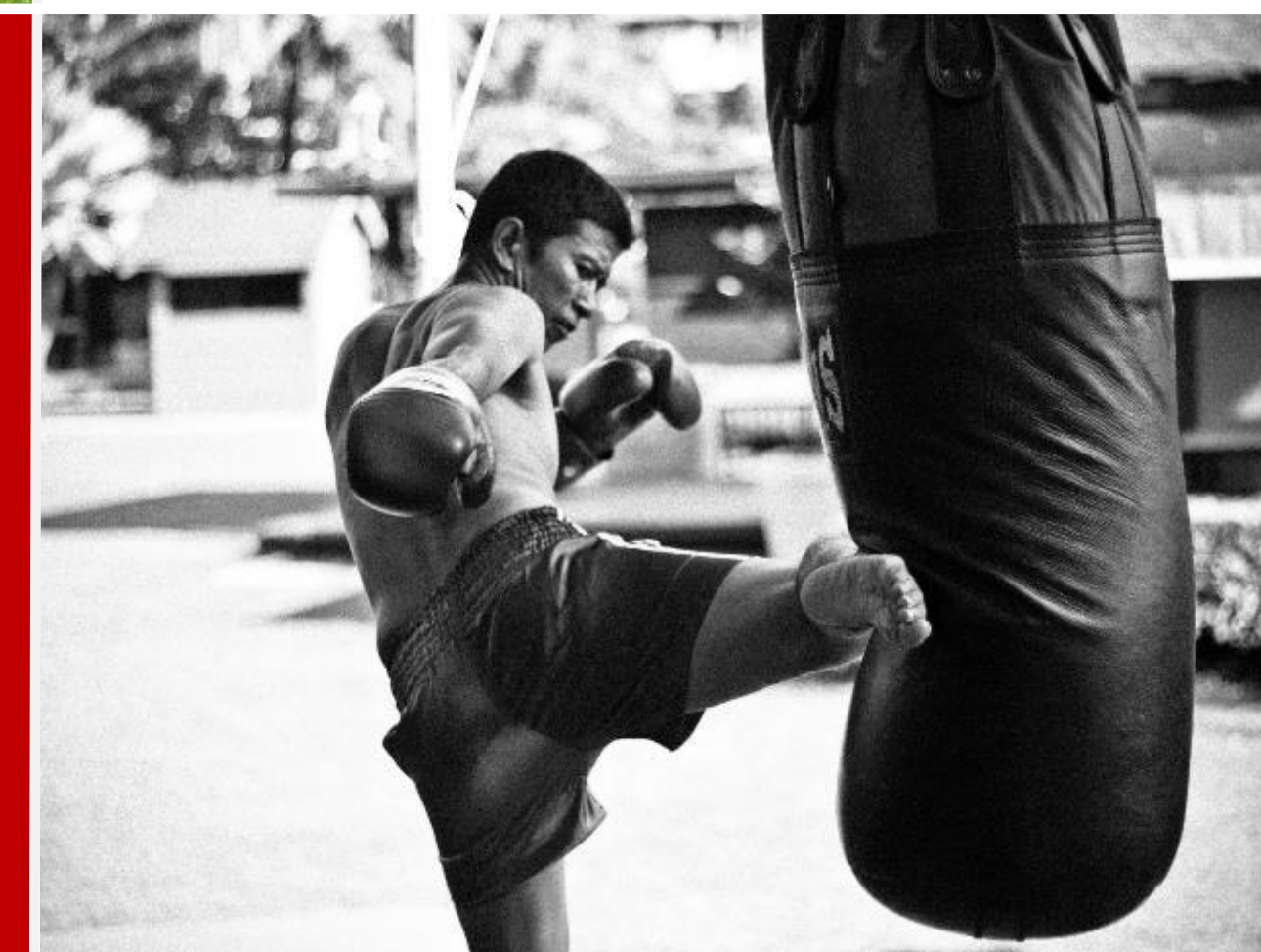

DIVING

Explore the house reef to see
corals, fishes and other
marine life.



KAYAKING/ PADDLEBOARDING

Complimentary kayaks are
available during high tide.

MEETINGS & EVENTS

Meetings at Phuket Marriott Resort & Spa, Merlin Beach are inspirational and driven by innovation. From creative spaces, delectable cuisine and signature Thai hospitality, we deliver extraordinary experiences.



BANQUET CAPACITIES

MEETING ROOM	Dimension (sq.m.)	CAPACITIES					
		Theatre	Boardroom	Classroom	U-Shape	Cocktail	Dining
Merlin Grand Ballroom	29.40 x 19.50	650	60 - 70	200 - 240	145	550	300 - 350
Merlin Ballroom A	13.60 x 9.75	80	20 - 30	45 - 60	35 - 50	120	50 - 60
Merlin Ballroom B	13.60 x 9.75	80	20 - 30	45 - 60	35 - 50	120	50 - 60
Merlin Ballroom C	15.80 x 19.50	200	30 - 35	120 - 140	108	280	120 - 150
Merlin Ballroom A & B	13.60 x 19.50	180	50 - 60	100 - 120	60 - 100	240	100 - 120
Vanda Board Room	7.60 x 11.10	60	24	30 - 40	30 - 36	30 - 50	40 - 50
Mokara 1 & 2	8 x 9	60	-	30	20	60 - 80	40
Mokara 1	4 x 9	30	20	15	20	30 - 40	20
Mokara 2	4 x 9	30	20	15	20	30 - 40	20
Farland	4 x 7	16	10	9	-	10	-

Large Functions

Merlin Grand Ballroom

The Merlin Grand Ballroom is a dynamic, multi-purpose venue capable of hosting creative meeting and events. Boasting state-of-the-art lighting and sound system, this space allows for inspiring visuals and immersive experiences for celebrations and meetings of all kinds.



Boardroom

Vanda



The well-appointed ballroom can seat up to 12 delegates.



Flexible Meeting Spaces

Mokara

This dynamic room allows delegates to organize purposeful meetings to inspire new ideas and explore new avenues of thinking.



Small Workshops

Farland

This daylight boardroom is the perfect setting to engage in meaningful dialogue in order to reach a decision.



Creative Meeting Spaces

Balls & Burgers

This versatile meeting space can be turned into a venue for workshops for educational and ideation purposes. Whether the team is learning new skills or generating new ideas, Balls & Burgers' flexible space will help you achieve your meeting goals.



MEETING SPACES

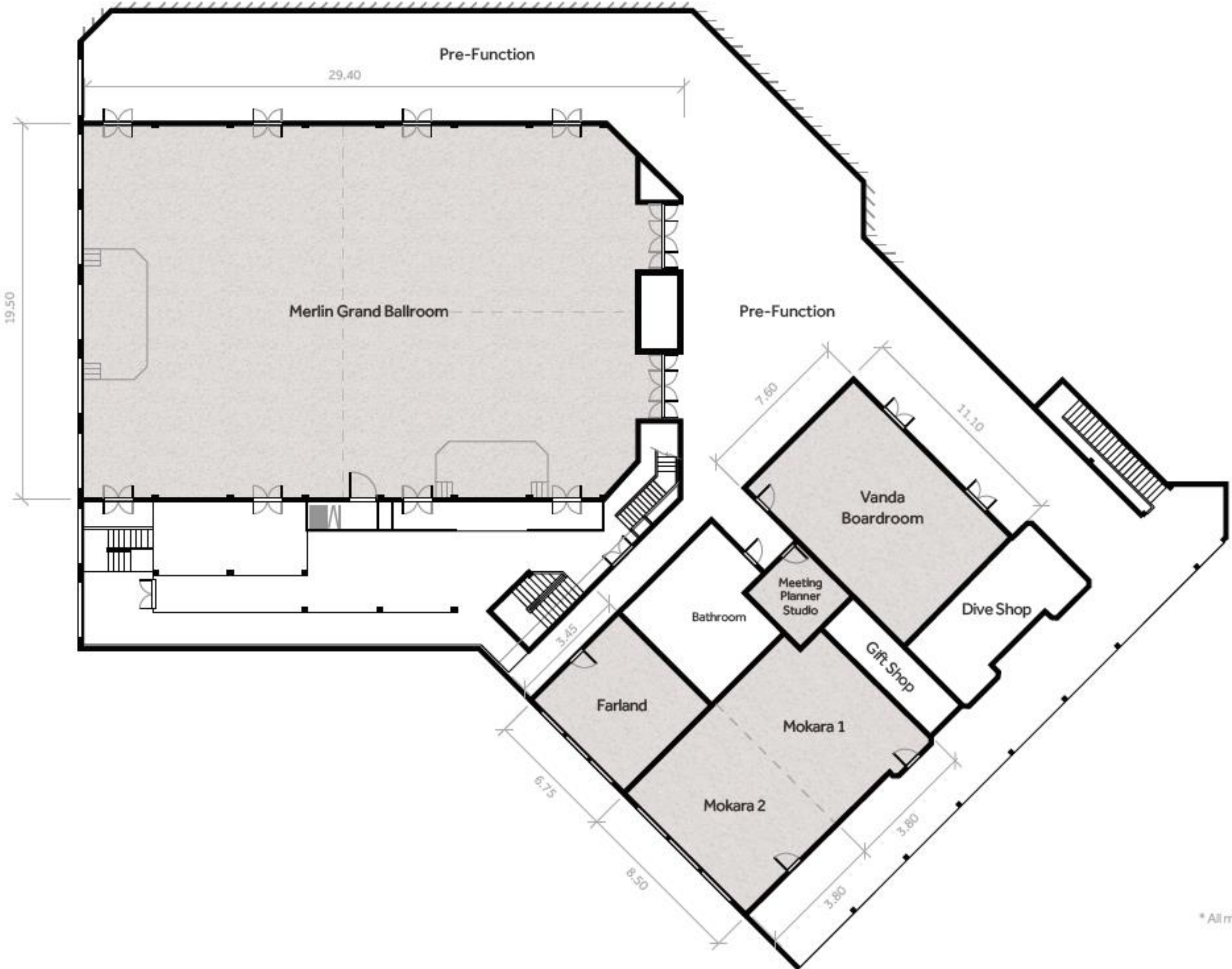

* All measurements are in meters.

EVENT GALLERY



EVENT GALLERY



HOTEL GALLERY

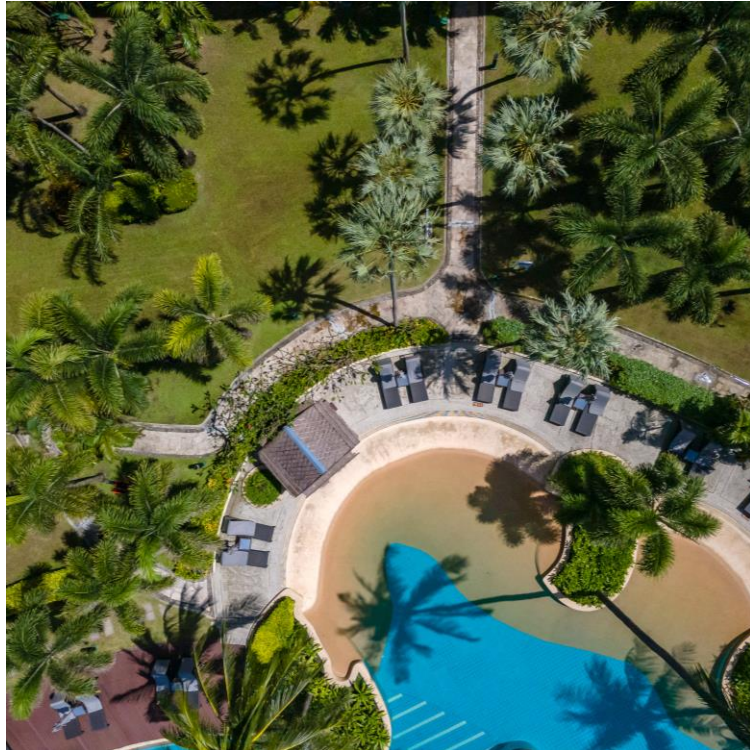

THANK YOU

